



© beim Hersteller
Archiv Michael Otto

BOZAK LOUDSPEAKERS

THE BOZAK ENSEMBLES



For “decorator” interiors deserving of truly fine furniture, we offer four matched ensembles — decorator-designed with provision for easy change of grille cloth to match your color scheme. For average-size rooms the one-woofer B-300 or B-302A Speakers, shown here, are ideal; the two-woofer B-305 (Page 7) is in a class by itself for larger rooms. Equipment Cabinets are available with single or double lift-tops. Since no two wood panels picked at random are likely to have the same grain, and different grainings take a finish differently, it is necessary to order an Ensemble as a matched set to assure uniformity of grain and color.

EQUIPMENT CABINET
TOP VIEW / INSIDE DIMENSIONS

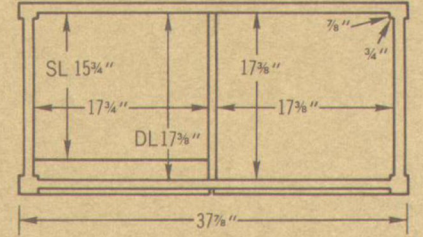

ITALIAN PROVINCIAL

This charming group, with its uncompromising authenticity of style and precision of sound, will reward the most critical taste for years to come. A satiny hand-rubbed fruitwood finish accents the graceful proportions of the cabinets, deep carving of the full-length solid-cherry legs and moulding, rich graining of the cherry panels, and basket-weave grille cloth.

SPEAKER SPECIFICATIONS: Pages 6 and 7
EQUIPMENT CABINET C-305-IP: 38"W, 20"D, 30"H, 100 lb / **SPEAKER SYSTEMS: B-300—302A-IP:** 24"W, 18 1/2"D, 30"H, 85 and 100 lb / Fruitwood on genuine cherry.



*c-beim Hersteller
Archiv Michael Otto*



**EQUIPMENT CABINET
TOP VIEW/INSIDE DIMENSIONS**

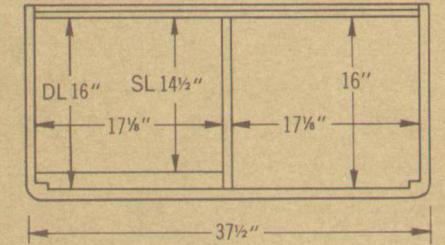

FRENCH PROVINCIAL

The gracious curves of Bozak's French Provincial style make it a tasteful focal point for any room decorated in the traditional manner. The genuine cherry wood surfaces may be finished in cherry, light fruitwood or dark fruitwood. An antique bronze metal grille overlays the changeable grille cloth for an added touch of interest. Like the period of history it reflects, Bozak's French Provincial will remain in vogue for years to come.

SPEAKER SPECIFICATIONS: Pages 6 and 7.

EQUIPMENT CABINET C-305-FP: 40"W, 20"D, 31"H, 100 lb./**SPEAKER SYSTEMS: B-300 — 302A-FP:** 28"W, 19"D, 31"H, 85 and 100 lb./Cherry with cherry, light fruitwood or dark fruitwood finish.

*© beim Hersteller
Archiv Michael Otto*



NOTE: French Provincial enclosures not available for Model B-305 Speaker Systems.

FOR THE CONTEMPORARY MINDED



Just as Bozak's period ensembles add a grace note to rooms furnished in the traditional manner, so do the two contemporary stylings available accent rooms in the modern idiom. As with the traditional speaker enclosures, grille cloths are easily changed to suit the mood of your room.

EQUIPMENT CABINET
TOP VIEW / INSIDE DIMENSIONS

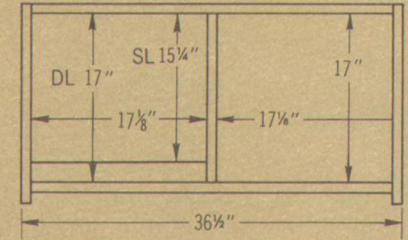

URBAN

The best and most enduring of contemporary design is evident in the pleasing proportions and classic simplicity of the Urban cabinets, set off by the subtle richness of matte-finished walnut and blond grille cloth. This group is "at home" in tasteful modern and traditional settings alike. On special order the Urban Ensemble is also available in hand-rubbed genuine mahogany.

SPEAKER SPECIFICATIONS: Pages 6 and 7.

EQUIPMENT CABINET C-305-U: 36 1/2"W, 20"D, 30 1/4"H, 110 lb / **SPEAKER SYSTEMS B-300-302A-U:** 24"W, 20"D, 30 1/4"H, 90 and 100 lb / Matte Walnut.





EQUIPMENT CABINET TOP VIEW/INSIDE DIMENSIONS

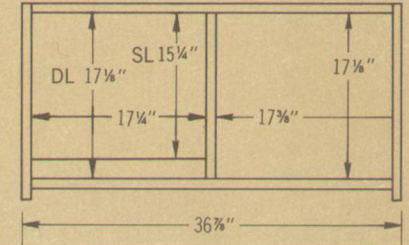

TANGLEWOOD

Contemporary with a more solid "feel" and a lowboy look is expressed in Tanglewood styling. The use of pedestal bases, rather than legs, adds mass to the visual effect. Vertical stripes on the grille cloth provide a three-dimensional perspective, providing counterpoint with the plane surface of the equipment cabinet. Available in Bozak's traditionally fine matte finish walnut or in cherry wood with a polished dark fruitwood finish.

SPEAKER SPECIFICATIONS: Pages 6 and 7.

EQUIPMENT CABINET C-305-T: 36 1/2"W, 20"D, 27 5/8"H, 110 lb./**SPEAKER SYSTEMS: B-300 — 302A-T:** 24"W, 20"D, 27 5/8"H, 90 and 100 lb./Matte walnut or polished dark fruitwood finish on cherry.

*© beim Hersteller
Archiv Michael Otto*



BOZAK CONCERT SERIES

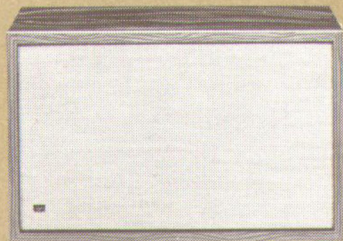

B-211 / SONATA II Here is the finest bookshelf speaker made. New design features, exclusive with Bozak, give it incomparable spaciousness, transparency and detail, with solos and any size of ensemble — the most natural musical quality ever achieved in so small a cabinet. Unlike any other bookshelf unit, it is in a class by itself and actually sounds best on a shelf! In money as in music, Sonata II is the biggest value available.

B-211 / One each B-199A Bass and single B-200Y Treble Speaker with LC Crossover Network / 50-16,000 cycles / Crossover 6 db per octave at 2500 cycles / 8 ohms / 20 watts RMS or more / 23 $\frac{1}{8}$ " x 14 $\frac{1}{4}$ " x 11 $\frac{1}{2}$ "D / 50 lb / Matte-finished walnut with natural-linen grille cloth / Stands vertically or horizontally.

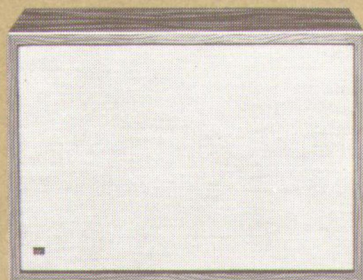

B-312 / CONCERTO II In keeping with our policy of filling the widest variety of needs with the finest equipment possible, we present the new Concerto II — a "compact", intermediate in size but a giant in music. With the new Bozak "spacious sound" design, its performance — and appearance — are equally superb on shelf or floor, with the true musical quality that distinguishes every size of Bozak. Here is the outstanding value in its class.

B-313 / CONCERTO III For the most precise re-creation of music by any speaker in the Compact class, Bozak presents the three-way B-313. In den or library its spaciousness, clarity, and naturalness make it the most outstanding of all compact speakers.

B-312 / One B-207A Coaxial Speaker / 45-16,000 cycles / Crossover 6 db per octave at 2500 cycles / 8 ohms / 20 watts RMS or more / 24 $\frac{1}{2}$ " x 17 $\frac{1}{4}$ " x 12 $\frac{1}{2}$ "D / 60 lb / Matte-finished walnut with natural-linen grille cloth / Stands vertically or horizontally.

B-313 / One each B-207A Coaxial and B-209B (8-ohm) Midrange Speaker, and N-10102A Crossover Network / 45-16,000 cycles / Crossovers 6 db per octave at 800 and 2500 cycles / 8 ohms / 20 watts RMS or more / Cabinet dimensions, same as B-312 / 70 lb.

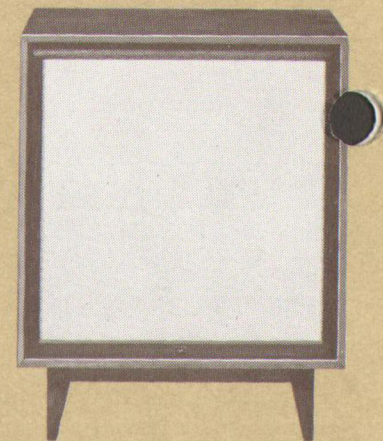

B-300 / CONCERTO IV When you have space for fine furniture to complement a tasteful living room, CONCERTO IV in Italian Provincial or Urban offers a unique combination of musical realism, capacity for growth, authentic styling, and modest cost. Its full-range coaxial speaker in a 5-cubic-foot infinite-baffle enclosure encompasses effectively the entire musical spectrum with an outstandingly robust, natural quality. Provision is made for the addition of a midrange speaker and crossover network at a later date for easy conversion to a three-way B-302A system.

B-302A / CONCERTO V The transparent middle frequencies,

BOZAK CONCERT SERIES



B-310 / B-310A / B-410 / THE CONCERT GRANDS

The supreme experience in music-listening is a concert heard through Bozak Concert Grands. These magnificent instruments, the final stages of Systematic Growth in the Concert Series, are recognized as The Supreme Achievements in The Re-Creation of Sound. With their four woofers, dual midrange units, and four pair of tweeters on a large panel, they encompass the entire musical spectrum and handle 60 watts RMS or more with a robustness, clarity and precision unapproached by any other speakers of any size and price.

The three models of Concert Grand differ in styling and the arrangement of the treble speakers. B-310A has the traditional spherical array with its broad horizontal and vertical dispersion; B-310B and B-410 have the slot-loaded vertical array with broader horizontal and limited vertical coverage.

CONCERT GRANDS I, II and III / Four B-199A Bass, two 16-ohm B-209B Mid-range, four pair B-200Y Treble Speakers, with N-104 (or N-10102A with N-25) Crossover Network / 28-20,000 cycles / Crossovers 6 db per octave at 400 and 2500 cycles / 8 ohms / 60 watts RMS or more / 36"W, 19"D, 52"H / 225 lb / Matte Walnut.

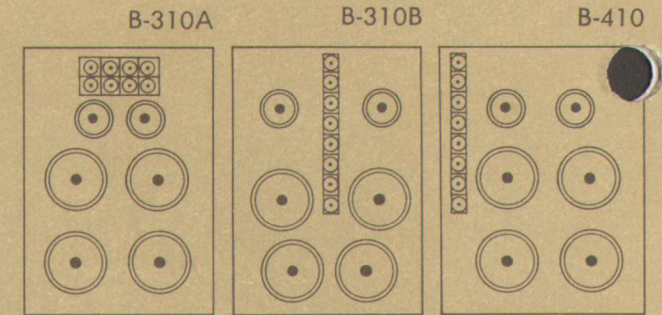

PANEL DIMENSIONS ON PAGE 15

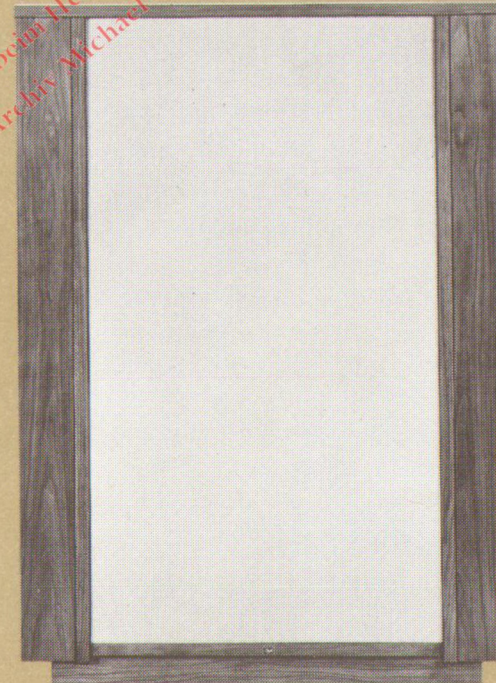

B-310A/B-310B

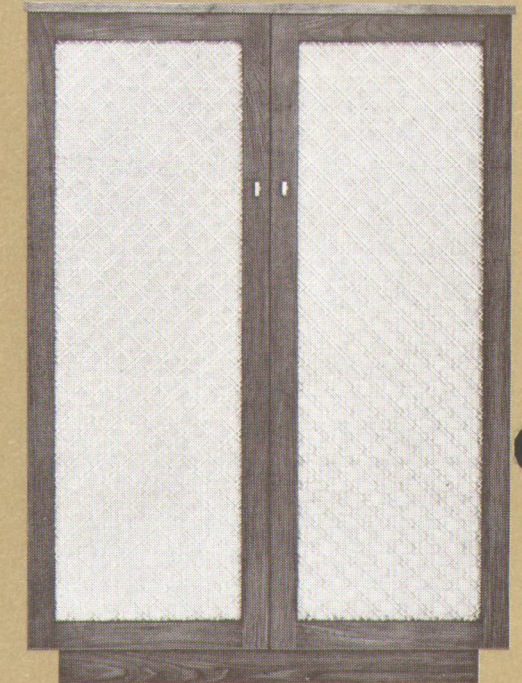

B-410

*bein Hersteller
Archiv Michael Otto*





This portable, completely-weather-proof unit stands first among all outdoor speakers in quality of sound. At pool or patio, and on your Christmas doorstep, it brings the music of the season with greater precision than many "indoor" speakers costing far more. You can install your Bard anywhere, or easily tote its 20 pounds by the convenient handle. It hangs or stands on its steady bracket and tilts to four positions. Totally unaffected by rain, sleet and snow, it can be washed by the garden hose.

One B-800 Wide-Range Speaker
8 ohms / 15 watts RMS or more
18" diam, 12"D, 21"H / 20 lb
Enameled in sandalwood beige
or eggshell white
with burnished-gold trim.

Hersteller
Michael Otto



Bozak

© Betty Henseller
Archie Mitchell, Onto